

TLT LLP

One Redcliff Street
Bristol BS1 6TP
T +44 (0)333 006 0000
F +44 (0)333 006 0011
DX 7815 Bristol

www.TLTsolicitors.com
Our ref 303L/PU01/96369/28
Your ref

JS 4954 7350 3GB

SD 1pm

046377

Paired £100
113 354803 JK

Appendix A



South Cambridgeshire District Council
Licensing Section
South Cambridgeshire Hall
Cambourne Business Park
CAMBOURNE
CB23 6EA

By special delivery

Direct tel +44 (0)333 006 0213 Date 19 November 2018
Direct fax +44 (0)333 006 1492 Email paul.uren@TLTsolicitors.com

Please note telephone calls may be recorded for training or regulatory purposes

Dear Sirs

Licensing Act 2003: New premises licence application
LJ's Sandwich Bar & Barista 40 Church Street Gamlingay Sandy SG19 3JH

We are assisting CPL Training Limited in the submission of the above application, together with related documentation, for their client Luigi Lanni, in relation to the above.

We enclose:

- Application form for a new premises licence with related documentation; and
- The appropriate fee.

We confirm that copies of the application, and its enclosures, have been sent to:

Police
Fire Officer
Environmental Health Office
Trading Standards
Health and Safety
Planning Authority
Child Protection Agency
Health Board
Home Office (Immigration Enforcement)

A copy of the newspaper in which the advertisement appears, and confirmation of display of advertisement on site, will follow separately.

Kindly acknowledge receipt confirming the date of receipt.

Letter to Local Authority re Premises and Personal Licence Applications

TLT LLP is a limited liability partnership registered in England & Wales (number OC 308658) whose registered office is at One Redcliff Street Bristol BS1 6TP.
A list of members is available for inspection at that address.

TLT LLP is authorised and regulated by the Solicitors Regulation Authority number 406297.

TLT LLP is authorised and regulated by the Financial Conduct Authority under reference number FRN 780419. Details of our FCA permissions can be found on the Financial Services Register at <https://register.fca.org.uk/>.



Should you wish to discuss the enclosed application then please contact the writer.

Yours faithfully

TLT

TLT LLP

enc Application form
 Consent from DPS
 New premises licence fee
 Plan

**Application for a premises licence to be granted
under the Licensing Act 2003**

PLEASE READ THE FOLLOWING INSTRUCTIONS FIRST

Before completing this form please read the guidance notes at the end of the form. If you are completing this form by hand please write legibly in block capitals. In all cases ensure that your answers are inside the boxes and written in black ink. Use additional sheets if necessary.

You may wish to keep a copy of the completed form for your records.

I/We Luigi Lanni

(Insert name(s) of applicant)

apply for a premises licence under section 17 of the Licensing Act 2003 for the premises described in Part 1 below (the premises) and I/we are making this application to you as the relevant licensing authority in accordance with section 12 of the Licensing Act 2003

Part 1 – Premises details

Postal address of premises or, if none, ordnance survey map reference or description LJ's Sandwich Bar & Barista 40 Church Street Gamlingay			
Post town	Sandy	Postcode	SG19 3JH

Telephone number at premises (if any)	n/a
Non-domestic rateable value of premises	£2,700 (Band A)

Part 2 - Applicant details

Please state whether you are applying for a premises licence as appropriate

Please tick as

- | | | |
|--|-------------------------------------|-----------------------------|
| a) an individual or individuals * | <input checked="" type="checkbox"/> | please complete section (A) |
| b) a person other than an individual * | | |
| i as a limited company/limited liability partnership | <input type="checkbox"/> | please complete section (B) |
| ii as a partnership (other than limited liability) | <input type="checkbox"/> | please complete section (B) |
| iii as an unincorporated association or | <input type="checkbox"/> | please complete section (B) |
| iv other (for example a statutory corporation) | <input type="checkbox"/> | please complete section (B) |
| c) a recognised club | <input type="checkbox"/> | please complete section (B) |

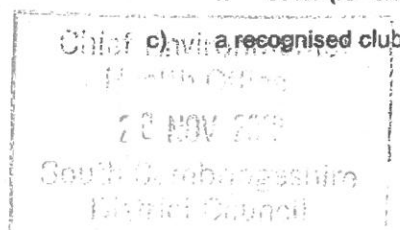

- d) a charity ☐ please complete section (B)
- e) the proprietor of an educational establishment ☐ please complete section (B)
- f) a health service body ☐ please complete section (B)
- g) a person who is registered under Part 2 of the Care Standards Act 2000 (c14) in respect of an independent hospital in Wales ☐ please complete section (B)
- ga) a person who is registered under Chapter 2 of Part 1 of the Health and Social Care Act 2008 (within the meaning of that Part) in an independent hospital in England ☐ please complete section (B)
- h) the chief officer of police of a police force in England and Wales ☐ please complete section (B)

* If you are applying as a person described in (a) or (b) please confirm (by ticking yes to one box below):

- I am carrying on or proposing to carry on a business which involves the use of the premises for licensable activities; or ☒
- I am making the application pursuant to a
- statutory function or ☐
- a function discharged by virtue of Her Majesty's prerogative ☐

(A) INDIVIDUAL APPLICANTS (fill in as applicable)

Mr <input checked="" type="checkbox"/>	Mrs <input type="checkbox"/>	Miss <input type="checkbox"/>	Ms <input type="checkbox"/>	Other Title (for example, Rev)	
Surname Lanni			First names Luigi		
Date of birth 01/05/1961 or over			I am 18 years old <input checked="" type="checkbox"/> Please tick yes		
Nationality Italian					
Current residential address if different from premises address		18 Victoria Close Wrestlingworth			
Post town	Sandy			Postcode	SG19 2EF
Daytime contact telephone number					
E-mail address (optional)					

SECOND INDIVIDUAL APPLICANT (if applicable)

Mr <input type="checkbox"/>	Mrs <input type="checkbox"/>	Miss <input type="checkbox"/>	Ms <input type="checkbox"/>	Other Title (for example, Rev)	
-----------------------------	------------------------------	-------------------------------	-----------------------------	--------------------------------	--

Surname		First names	
Date of birth over		I am 18 years old or	<input type="checkbox"/> Please tick yes
Nationality			
Current residential address if different from premises address			
Post town		Postcode	
Daytime contact telephone number			
E-mail address (optional)			

(B) OTHER APPLICANTS

Please provide name and registered address of applicant in full. Where appropriate please give any registered number. In the case of a partnership or other joint venture (other than a body corporate), please give the name and address of each party concerned.

Name
Address
Registered number (where applicable)
Description of applicant (for example, partnership, company, unincorporated association etc.)
Telephone number (if any)
E-mail address (optional)

Part 3 Operating Schedule

When do you want the premises licence to start?

DD	MM	YYYY
A	S	A P

If you wish the licence to be valid only for a limited period, when do you want it to end?

DD	MM	YYYY

Please give a general description of the premises (please read guidance note 1)
Bistro.

If 5,000 or more people are expected to attend the premises at any one time, please state the number expected to attend.

n/a

What licensable activities do you intend to carry on from the premises?

(please see sections 1 and 14 and Schedules 1 and 2 to the Licensing Act 2003)

Provision of regulated entertainment (please read guidance note 2)

Please tick all that apply

- | | |
|---|--------------------------|
| a) plays (if ticking yes, fill in box A) | <input type="checkbox"/> |
| b) films (if ticking yes, fill in box B) | <input type="checkbox"/> |
| c) indoor sporting events (if ticking yes, fill in box C) | <input type="checkbox"/> |
| d) boxing or wrestling entertainment (if ticking yes, fill in box D) | <input type="checkbox"/> |
| e) live music (if ticking yes, fill in box E) | <input type="checkbox"/> |
| f) recorded music (if ticking yes, fill in box F) | <input type="checkbox"/> |
| g) performances of dance (if ticking yes, fill in box G) | <input type="checkbox"/> |
| h) anything of a similar description to that falling within (e), (f) or (g) (if ticking yes, fill in box H) | <input type="checkbox"/> |

Provision of late night refreshment (if ticking yes, fill in box I)



Supply of alcohol (if ticking yes, fill in box J)



In all cases complete boxes K, L and M

A

Plays Standard days and timings (please read guidance note 7)			Will the performance of a play take place indoors or outdoors or both – please tick (please read guidance note 3)	Indoors	<input type="checkbox"/>
				Outdoors	<input type="checkbox"/>
				Both	<input type="checkbox"/>
Day	Start	Finish			
Mon			Please give further details here (please read guidance note 4)		
Tue					
Wed			State any seasonal variations for performing plays (please read guidance note 5)		
Thur					
Fri			Non standard timings. Where you intend to use the premises for the performance of plays at different times to those listed in the column on the left, please list (please read guidance note 6)		
Sat					
Sun					

B

Films Standard days and timings (please read guidance note 7)			Will the exhibition of films take place indoors or outdoors or both – please tick (please read guidance note 3)		Indoors	<input type="checkbox"/>
					Outdoors	<input type="checkbox"/>
					Both	<input type="checkbox"/>
Day	Start	Finish				
Mon			Please give further details here (please read guidance note 4)			
Tue						
Wed			State any seasonal variations for the exhibition of films (please read guidance note 5)			
Thur						
Fri			Non standard timings. Where you intend to use the premises for the exhibition of films at different times to those listed in the column on the left, please list (please read guidance note 6)			
Sat						
Sun						

C

Indoor sporting events Standard days and timings (please read guidance note 7)			<u>Please give further details</u> (please read guidance note 4)
Day	Start	Finish	
Mon			
Tue			<u>State any seasonal variations for indoor sporting events</u> (please read guidance note 5)
Wed			
Thur			<u>Non standard timings. Where you intend to use the premises for indoor sporting events at different times to those listed in the column on the left, please list</u> (please read guidance note 6)
Fri			
Sat			
Sun			

D

Boxing or wrestling entertainments Standard days and timings (please read guidance note 7)			Will the boxing or wrestling entertainment take place indoors or outdoors or both – please tick (please read guidance note 3)	Indoors	<input type="checkbox"/>
				Outdoors	<input type="checkbox"/>
				Both	<input type="checkbox"/>
Day	Start	Finish	Please give further details here (please read guidance note 4)		
Mon					
Tue			State any seasonal variations for boxing or wrestling entertainment (please read guidance note 5)		
Wed			Non standard timings. Where you intend to use the premises for boxing or wrestling entertainment at different times to those listed in the column on the left, please list (please read guidance note 6)		
Thur					
Fri					
Sat					
Sun					

E

Live music Standard days and timings (please read guidance note 7)			Will the performance of live music take place indoors or outdoors or both – please tick (please read guidance note 3)		Indoors <input type="checkbox"/>
					Outdoors <input type="checkbox"/>
					Both <input type="checkbox"/>
Day	Start	Finish	Please give further details here (please read guidance note 4)		
Mon					
Tue					
			State any seasonal variations for the performance of live music (please read guidance note 5)		
Wed					
Thur					
			Non standard timings. Where you intend to use the premises for the performance of live music at different times to those listed in the column on the left, please list (please read guidance note 6)		
Fri					
Sat					
Sun					

F

Recorded music Standard days and timings (please read guidance note 7)			Will the playing of recorded music take place indoors or outdoors or both – please tick (please read guidance note 3)		Indoors	<input type="checkbox"/>
					Outdoors	<input type="checkbox"/>
					Both	<input type="checkbox"/>
Day	Start	Finish	Please give further details here (please read guidance note 4)			
Mon						
Tue						
Wed						
Thur			State any seasonal variations for the playing of recorded music (please read guidance note 5)			
Fri			Non standard timings. Where you intend to use the premises for the playing of recorded music at different times to those listed in the column on the left, please list (please read guidance note 6)			
Sat						
Sun						

G

Performances of dance Standard days and timings (please read guidance note 7)			Will the performance of dance take place indoors or outdoors or both - please tick (please read guidance note 3)	Indoors	<input type="checkbox"/>
Day	Start	Finish		Outdoors	<input type="checkbox"/>
Mon			Please give further details here (please read guidance note 4)	Both	<input type="checkbox"/>
Tue					
Wed			State any seasonal variations for the performance of dance (please read guidance note 5)		
Thur					
Fri			Non standard timings. Where you intend to use the premises for the performance of dance at different times to those listed in the column on the left, please list (please read guidance note 6)		
Sat					
Sun					

H

Anything of a similar description to that falling within (e), (f) or (g) Standard days and timings (please read guidance note 7)			Please give a description of the type of entertainment you will be providing	
Day	Start	Finish	Will this entertainment take place indoors or outdoors or both – please tick (please read guidance note 3)	Indoors <input type="checkbox"/>
Mon				Outdoors <input type="checkbox"/>
			Both <input type="checkbox"/>	
Tue			Please give further details here (please read guidance note 4)	
Wed				
Thur			State any seasonal variations for entertainment of a similar description to that falling within (e), (f) or (g) (please read guidance note 5)	
Fri				
Sat			Non standard timings. Where you intend to use the premises for the entertainment of a similar description to that falling within (e), (f) or (g) at different times to those listed in the column on the left, please list (please read guidance note 6)	
Sun				

J

Supply of alcohol Standard days and timings (please read guidance note 7)			Will the supply of alcohol be for consumption – please tick (please read guidance note 8)	On the premises	<input type="checkbox"/>
				Off the premises	<input type="checkbox"/>
				Both	<input checked="" type="checkbox"/>
Day	Start	Finish	State any seasonal variations for the supply of alcohol (please read guidance note 5)		
Mon	11:00	23:30			
Tue	11:00	23:30			
Wed	11:00	23:30			
Thur	11:00	23:30	Non standard timings. Where you intend to use the premises for the supply of alcohol at different times to those listed in the column on the left, please list (please read guidance note 6)		
Fri	11:00	23:30			
Sat	11:00	23:30			
Sun	11:00	23:30			

State the name and details of the individual whom you wish to specify on the licence as designated premises supervisor (Please see declaration about the entitlement to work in the checklist at the end of the form):

Name Luigi Lanni	
Date of birth 01/05/1961	
Address 18 Victoria Close Wrestlingworth Sandy	
Postcode	SG19 2EF
Personal licence number (if known) 18/050959	
Issuing licensing authority (if known) Central Bedfordshire Council	

K

Late night refreshment Standard days and timings (please read guidance note 7)			Will the provision of late night refreshment take place indoors or outdoors or both – please tick (please read guidance note 3)	Indoors	<input checked="" type="checkbox"/>
				Outdoors	<input type="checkbox"/>
Day	Start	Finish		Both	<input type="checkbox"/>
Mon	23:00	23:30	<u>Please give further details here</u> (please read guidance note 4) Hot food or drink after 23:00h		
Tue	23:00	23:30			
Wed	23:00	23:30	<u>State any seasonal variations for the provision of late night refreshment</u> (please read guidance note 5)		
Thur	23:00	23:30			
Fri	23:00	23:30	<u>Non standard timings. Where you intend to use the premises for the provision of late night refreshment at different times, to those listed in the column on the left, please list</u> (please read guidance note 6)		
Sat	23:00	23:30			
Sun	23:00	23:30			

Please highlight any adult entertainment or services, activities, other entertainment or matters ancillary to the use of the premises that may give rise to concern in respect of children (please read guidance note 9).

L

Hours premises are open to the public Standard days and timings (please read guidance note 7)			State any seasonal variations (please read guidance note 5)
Day	Start	Finish	
Mon	07:00	00:00	Non standard timings. Where you intend the premises to be open to the public at different times from those listed in the column on the left, please list (please read guidance note 6)
Tue	07:00	00:00	
Wed	07:00	00:00	
Thur	07:00	00:00	
Fri	07:00	00:00	
Sat	07:00	00:00	
Sun	07:00	00:00	

M Describe the steps you intend to take to promote the four licensing objectives:

a) General – all four licensing objectives (b, c, d and e) (please read guidance note 10)

Please see attached.

b) The prevention of crime and disorder

Please see attached.

c) Public safety

Please see attached.

d) The prevention of public nuisance

Please see attached.

e) The protection of children from harm

Please see attached.

Part 4 – Signatures (please read guidance note 11)

Signature of applicant or applicant's solicitor or other duly authorised agent (see guidance note 12). If signing on behalf of the applicant, please state in what capacity.

Declaration	<ul style="list-style-type: none">• [Applicable to individual applicants only, including those in a partnership which is not a limited liability partnership] I understand I am not entitled to be issued with a licence if I do not have the entitlement to live and work in the UK (or if I am subject to a condition preventing me from doing work relating to the carrying on of a licensable activity) and that my licence will become invalid if I cease to be entitled to live and work in the UK (please read guidance note 15).• The DPS named in this application form is entitled to work in the UK (and is not subject to conditions preventing him or her from doing work relating to a licensable activity) and I have seen a copy of his or her proof of entitlement to work, if appropriate (please see note 15).
Signature	
Date	18.11.2018
Capacity	

For joint applications, signature of 2nd applicant or 2nd applicant's solicitor or other authorised agent (please read guidance note 13). If signing on behalf of the applicant, please state in what capacity.

Signature	
Date	
Capacity	

Contact name (where not previously given) and postal address for correspondence associated with this application (please read guidance note 14)

Paul Uren
TLT LLP
One Redcliff Street

Checklist:

Please tick to indicate agreement

- I have made or enclosed payment of the fee. (paid online) ☒
- I have enclosed the plan of the premises. ☒
- I have sent copies of this application and the plan to responsible authorities and others where applicable. (submitted online – LA to distribute to RA's) ☒
- I have enclosed the consent form completed by the individual I wish to be designated premises supervisor, if applicable. (see comments and covering letter of application) ☐
- I understand that I must now advertise my application. ☒
- I understand that if I do not comply with the above requirements my application will be rejected. ☒
- [Applicable to all individual applicants, including those in a partnership which is not a limited liability partnership, but not companies or limited liability partnerships] I have included documents demonstrating my entitlement to work in the United Kingdom (please read note 15). ☒

IT IS AN OFFENCE, UNDER SECTION 158 OF THE LICENSING ACT 2003, TO MAKE A FALSE STATEMENT IN OR IN CONNECTION WITH THIS APPLICATION. THOSE WHO MAKE A FALSE STATEMENT MAY BE LIABLE ON SUMMARY CONVICTION TO A FINE OF ANY AMOUNT.

IT IS AN OFFENCE UNDER SECTION 24B OF THE IMMIGRATION ACT 1971 FOR A PERSON TO WORK WHEN THEY KNOW, OR HAVE REASONABLE CAUSE TO BELIEVE, THAT THEY ARE DISQUALIFIED FROM DOING SO BY REASON OF THEIR IMMIGRATION STATUS. THOSE WHO EMPLOY AN ADULT WITHOUT LEAVE OR WHO IS SUBJECT TO CONDITIONS AS TO EMPLOYMENT WILL BE LIABLE TO A CIVIL PENALTY UNDER SECTION 15 OF THE IMMIGRATION, ASYLUM AND NATIONALITY ACT 2006 AND PURSUANT TO SECTION 21 OF THE SAME ACT, WILL BE COMMITTING AN OFFENCE WHERE THEY DO SO IN THE KNOWLEDGE, OR WITH REASONABLE CAUSE TO BELIEVE, THAT THE EMPLOYEE IS DISQUALIFIED.

Part 4 – Signatures (please read guidance note 11)

Signature of applicant or applicant's solicitor or other duly authorised agent (see guidance note 12). If signing on behalf of the applicant, please state in what capacity.

Declaration	<ul style="list-style-type: none">• [Applicable to individual applicants only, including those in a partnership which is not a limited liability partnership] I understand I, am not entitled to be issued with a licence if I do not have the entitlement to live and work in the UK (or if I am subject to a condition preventing me from doing work relating to the carrying on of a licensable activity) and that my licence will become invalid if I cease to be entitled to live and work in the UK (please read guidance note 15).• The DPS named in this application form is entitled to work in the UK (and is not subject to conditions preventing him or her from doing
--------------------	---

between 08.00 and 23.00 on any day, provided that the audience does not exceed 1000. Combined fighting sports – defined as a contest, exhibition or display which combines boxing or wrestling with one or more martial arts – are licensable as a boxing or wrestling entertainment rather than an indoor sporting event.

- Live music: no licence permission is required for:
 - a performance of unamplified live music between 08.00 and 23.00 on any day, on any premises.
 - a performance of amplified live music between 08.00 and 23.00 on any day on premises authorised to sell alcohol for consumption on those premises, provided that the audience does not exceed 500.
 - a performance of amplified live music between 08.00 and 23.00 on any day, in a workplace that is not licensed to sell alcohol on those premises, provided that the audience does not exceed 500.
 - a performance of amplified live music between 08.00 and 23.00 on any day, in a church hall, village hall, community hall, or other similar community premises, that is not licensed by a premises licence to sell alcohol, provided that (a) the audience does not exceed 500, and (b) the organiser gets consent for the performance from a person who is responsible for the premises.
 - a performance of amplified live music between 08.00 and 23.00 on any day, at the non-residential premises of (i) a local authority, or (ii) a school, or (iii) a hospital, provided that (a) the audience does not exceed 500, and (b) the organiser gets consent for the performance on the relevant premises from: (i) the local authority concerned, or (ii) the school or (iii) the health care provider for the hospital.
- Recorded Music: no licence permission is required for:
 - any playing of recorded music between 08.00 and 23.00 on any day on premises authorised to sell alcohol for consumption on those premises, provided that the audience does not exceed 500.
 - any playing of recorded music between 08.00 and 23.00 on any day, in a church hall, village hall, community hall, or other similar community premises, that is not licensed by a premises licence to sell alcohol, provided that (a) the audience does not exceed 500, and (b) the organiser gets consent for the performance from a person who is responsible for the premises.
 - any playing of recorded music between 08.00 and 23.00 on any day, at the non-residential premises of (i) a local authority, or (ii) a school, or (iii) a hospital, provided that (a) the audience does not exceed 500, and (b) the organiser gets consent for the performance on the relevant premises from: (i) the local authority concerned, or (ii) the school proprietor or (iii) the health care provider for the hospital.
- Dance: no licence is required for performances between 08.00 and 23.00 on any day, provided that the audience does not exceed 500. However, a performance which amounts to adult entertainment remains licensable.
- Cross activity exemptions: no licence is required between 08.00 and 23.00 on any day, with no limit on audience size for:
 - any entertainment taking place on the premises of the local authority where the entertainment is provided by or on behalf of the local authority;
 - any entertainment taking place on the hospital premises of the health care provider where the entertainment is provided by or on behalf of the health care provider;
 - any entertainment taking place on the premises of the school where the entertainment is provided by or on behalf of the school proprietor; and
 - any entertainment (excluding films and a boxing or wrestling entertainment) taking place at a travelling circus, provided that (a) it takes place within a moveable structure that accommodates the

audience, and (b) that the travelling circus has not been located on the same site for more than 28 consecutive days.

3. Where taking place in a building or other structure please tick as appropriate (Indoors may include a tent).
4. For example the type of activity to be authorised, if not already stated, and give relevant further details, for example (but not exclusively) whether or not music will be amplified or unamplified.
5. For example (but not exclusively), where the activity will occur on additional days during the summer months.
6. For example (but not exclusively), where you wish the activity to go on longer on a particular day e.g. Christmas Eve.
7. Please give timings in 24 hour clock (e.g. 16.00) and only give details for the days of the week when you intend the premises to be used for the activity.
8. If you wish people to be able to consume alcohol on the premises, please tick 'on the premises'. If you wish people to be able to purchase alcohol to consume away from the premises, please tick 'off the premises'. If you wish people to be able to do both, please tick 'both'.
9. Please give information about anything intended to occur at the premises or ancillary to the use of the premises which may give rise to concern in respect of children, regardless of whether you intend children to have access to the premises, for example (but not exclusively) nudity or semi-nudity, films for restricted age groups or the presence of gaming machines.
10. Please list here steps you will take to promote all four licensing objectives together.
11. The application form must be signed.
12. An applicant's agent (for example solicitor) may sign the form on their behalf provided that they have actual authority to do so.
13. Where there is more than one applicant, each of the applicants or their respective agent must sign the application form.
14. This is the address which we shall use to correspond with you about this application.

15. Entitlement to work/immigration status for individual applicants and applications from partnerships which are not limited liability partnerships:

A licence may not be held by an individual or an individual in a partnership who is resident in the UK who:

- does not have the right to live and work in the UK; or
- is subject to a condition preventing him or her from doing work relating to the carrying on of a licensable activity.

Any premises licence issued in respect of an application made on or after 6 April 2017 will become invalid if the holder ceases to be entitled to work in the UK.

Applicants must demonstrate that they have an entitlement to work in the UK and are not subject to a condition preventing them from doing work relating to the carrying on of a licensable activity. They do this by providing with this application copies or scanned copies of the following documents (which do not need to be certified).

Documents which demonstrate entitlement to work in the UK

- An expired or current passport showing the holder, or a person named in the passport as the child of the holder, is a British citizen or a citizen of the UK and Colonies having the right of abode in the UK [please see note below about which sections of the passport to copy].
- An expired or current passport or national identity card showing the holder, or a person named in the passport as the child of the holder, is a national of a European Economic Area country or Switzerland.

- A Registration Certificate or document certifying permanent residence issued by the Home Office to a national of a European Economic Area country or Switzerland.
- A Permanent Residence Card issued by the Home Office to the family member of a national of a European Economic Area country or Switzerland.
- A **current** Biometric Immigration Document (Biometric Residence Permit) issued by the Home Office to the holder indicating that the person named is allowed to stay indefinitely in the UK, or has no time limit on their stay in the UK.
- A **current** passport endorsed to show that the holder is exempt from immigration control, is allowed to stay indefinitely in the UK, has the right of abode in the UK, or has no time limit on their stay in the UK.
- A **current** Immigration Status Document issued by the Home Office to the holder with an endorsement indicating that the named person is allowed to stay indefinitely in the UK or has no time limit on their stay in the UK, **when produced in combination with** an official document giving the person's permanent National Insurance number and their name issued by a Government agency or a previous employer.
- A full birth or adoption certificate issued in the UK which includes the name(s) of at least one of the holder's parents or adoptive parents, **when produced in combination with** an official document giving the person's permanent National Insurance number and their name issued by a Government agency or a previous employer.
- A birth or adoption certificate issued in the Channel Islands, the Isle of Man or Ireland **when produced in combination with** an official document giving the person's permanent National Insurance number and their name issued by a Government agency or a previous employer.
- A certificate of registration or naturalisation as a British citizen, **when produced in combination with** an official document giving the person's permanent National Insurance number and their name issued by a Government agency or a previous employer.
- A **current** passport endorsed to show that the holder is allowed to stay in the UK and is currently allowed to work and is not subject to a condition preventing the holder from doing work relating to the carrying on of a licensable activity.
- A **current** Biometric Immigration Document (Biometric Residence Permit) issued by the Home Office to the holder which indicates that the named person can currently stay in the UK and is allowed to work relation to the carrying on of a licensable activity.
- A **current** Residence Card issued by the Home Office to a person who is not a national of a European Economic Area state or Switzerland but who is a family member of such a national or who has derivative rights or residence.
- A **current** Immigration Status Document containing a photograph issued by the Home Office to the holder with an endorsement indicating that the named person may stay in the UK, and is allowed to work and is not subject to a condition preventing the holder from doing work relating to the carrying on of a licensable activity **when produced in**

combination with an official document giving the person's permanent National Insurance number and their name issued by a Government agency or a previous employer.

- A Certificate of Application, **less than 6 months old**, issued by the Home Office under regulation 17(3) or 18A (2) of the Immigration (European Economic Area) Regulations 2006, to a person who is not a national of a European Economic Area state or Switzerland but who is a family member of such a national or who has derivative rights of residence.
- Reasonable evidence that the person has an outstanding application to vary their permission to be in the UK with the Home Office such as the Home Office acknowledgement letter or proof of postage evidence, or reasonable evidence that the person has an appeal or administrative review pending on an immigration decision, such as an appeal or administrative review reference number.
- Reasonable evidence that a person who is not a national of a European Economic Area state or Switzerland but who is a family member of such a national or who has derivative rights of residence in exercising treaty rights in the UK including:-
 - evidence of the applicant's own identity – such as a passport,
 - evidence of their relationship with the European Economic Area family member – e.g. a marriage certificate, civil partnership certificate or birth certificate, and
 - evidence that the European Economic Area national has a right of permanent residence in the UK or is one of the following if they have been in the UK for more than 3 months:
 - (i) working e.g. employment contract, wage slips, letter from the employer,
 - (ii) self-employed e.g. contracts, invoices, or audited accounts with a bank,
 - (iii) studying e.g. letter from the school, college or university and evidence of sufficient funds; or
 - (iv) self-sufficient e.g. bank statements.

Family members of European Economic Area nationals who are studying or financially independent must also provide evidence that the European Economic Area national and any family members hold comprehensive sickness insurance in the UK. This can include a private medical insurance policy, an EHIC card or an S1, S2 or S3 form.

Original documents must not be sent to licensing authorities. If the document copied is a passport, a copy of the following pages should be provided:-

- (i) any page containing the holder's personal details including nationality;
- (ii) any page containing the holder's photograph;
- (iii) any page containing the holder's signature;
- (iv) any page containing the date of expiry; and
- (v) any page containing information indicating the holder has permission to enter or remain in the UK and is permitted to work.

If the document is not a passport, a copy of the whole document should be provided.

Your right to work will be checked as part of your licensing application and this could involve us checking your immigration status with the Home Office. We may otherwise share information with the Home Office. Your licence application will not be determined until you have complied with this guidance.

LJ's Sandwich Bar & Bartista, 40 Church Street, Gamlingay, Sandy SG19 3JH
Proposed Licensing Conditions

General – all four licensing objectives

Locations of fire safety and other safety equipment subject to change in accordance with the requirements of the responsible authorities or following a risk assessment.

Any detail shown on the plan that is not required by the licensing plans regulations is indicative only and subject to change at any time.

Food will be available throughout the day with waiter/waitress service during peak times.

Prevention of crime and disorder

CCTV will be installed, operated and maintained in agreement with the Police. The system will enable frontal identification of every person entering the premises. The system will record in real time and operate whilst the premises are open for licensable activities. The recordings shall be kept available for a minimum of 31 days.

Recordings shall be made available immediately on request to an Authorised Officer or a Police Officer (subject to GDPR) throughout the 31-day period following any incident.

A member of staff with knowledge of the CCTV system will be present on site whilst the premises are open to the public to aid any enquiry from a Police Officer or Authorised Officer requiring recent CCTV recordings with the minimum of delay when requested.

Public Safety

Appropriate fire safety measures will be installed and maintained as shown on the drawings accompanying this application.

Staff will be trained in First Aid.

Adequate and appropriate first aid equipment and materials will be kept on site, regularly checked and kept in an easily accessible place for staff.

Public areas will be maintained free from obstruction and trip hazards.

All exit routes will be kept unobstructed, with non-slippery and even surfaces, free of trip hazards and clearly signed.

Prevention of Public Nuisance

All highway and public spaces in the vicinity of the premises will be kept free from litter to the satisfaction of the council.

Refuse such as bottles will be placed into receptacles outside the premise at times that will minimise the disturbance to nearby properties.

No deliveries will take place between 22:00 and 06:00 hours.

No collection, including refuse and recyclable food waste shall take place between 22:00 and 06:00 hours.

The courtyard will be closed to customers for the consumption of alcohol and/or food after 9pm every day.

Notices will be prominently displayed at all exits requesting patrons to leave the premises quietly.

Protection of children from harm

All staff shall be aware of the law regarding the refusal of service to any person who is drunk or is underage and shall be aware of how to seek ID from anyone who appears to be underage.

A 'challenge 21' policy will be adopted with proportionate and appropriate signage displayed.

A "refusal to serve log" will be maintained and made available for inspection to a Police Officer or Authorised Officer, this log shall include the Date, Time, Name and Signature of the staff member who refused the sale. This log will also be signed by the DPS of the premises on a monthly basis.

DPS CONSENT FORM

Consent of individual to being specified as premises supervisor

1 Luigi LANNI
(full name of prospective premises supervisor)

of

WRESHINGWORTH ROAD
(home address of prospective premises supervisor)

(date of birth)

ITALY
(place of birth)

ITALIAN
(nationality)

Hereby confirm that I give my consent to be specified as the designated premises supervisor in relation to the application for

New Premises Licence

(type of application)

By

Luigi Lanni
(name of applicant)

Relating to premises licence

N/A - IN TCT
(number of existing licence, if any)

For

SANDWICH BAR AND.
LY'S BARISTA
38 CHURCH STREET
GAILINGAY
SANDY SG19 3TH

(name and address of premises to which the application relates)

and any premises licence to be granted or varied in respect of this application made by

Luigi Lami

(name of applicant)

SANDWICH BAR AND

Concerning the supply of alcohol at

LY'S BARISTA
38 Church Street
Cambridgehire
Garlington.
SG19 3JH

(name and address of premises to which application relates)

I also confirm that I am entitled to work in the United Kingdom and am applying for, intend to apply for or currently hold a personal licence, details of which I set out below.

Personal Licence Number

18/050959

(insert personal licence number, if any)

Personal Licensing issuing Authority

CENTRAL BEDFORDSHIRE COUNCIL
Waking House, High Street North
Donstable, BEDS, LU6 2LF.

(insert name and address and telephone number of personal licence issuing authority, if any)

Signed

Name (please print)

Luigi Lami

Date

DRAWING SYMBOLS



: Fire Extinguisher - CO2



: Fire Extinguisher - Dry Powder



: Fire Extinguisher - Water



: Fire Extinguisher - Foam



: Licensed Area



: Fire Blanket

Notes:

This drawings have been produced to the standards set out within the Licensing Act 2003.

No deviation may be made from the details shown on this drawing without prior written permission of UK Surveyors. Any discrepancy found between this drawing and any other document should be referred immediately to UK Surveyors.

IF IN ANY DOUBT PLEASE ASK.

All rights described in chapter IV of copyright, design and Patents Act 1988 have been generally asserted.

GROUND FLOOR PLAN

Licensed Floor Area
Licensed Ground Floor Area: 143.0ms

Total Licensed Floor Area: 143ms

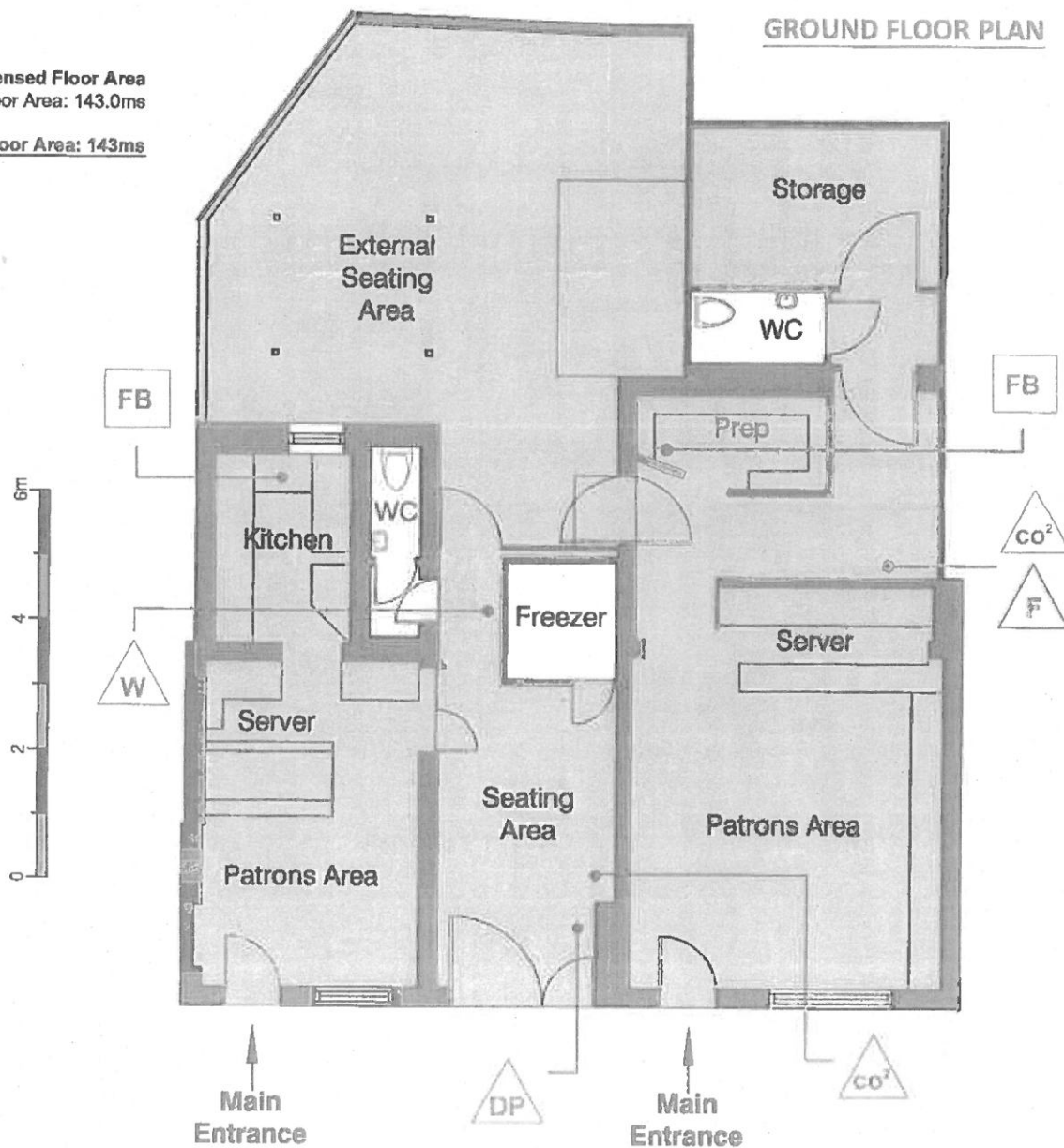

Drawing No:
004069

Drawing Title: Premises Licensing Plan

Property: LJS Sandwich Bar, 40 Church Street,
Gaminglay, Sandy, SG19 3JH

Date:
30/10/2018

Sheet:
1 of 1



UK Surveyors Ltd

CAD Drafting Planning Building Regulations Building Surveying Alcohol Licensing

☎: Freephone: 0808 168 9059
☎: Head Office: 01889 220-880
✉: enquiries@uksurveyors.net
🌐: www.uksurveyors.net

Drawn By:
OH

Scale:
1:100 @ A4